

**HAZELWOOD DRIVE, BURY, BL9 6QH**



- Semi Detached Property
- Requiring Modernisation
- Three Bedrooms
- Open Plan Lounge/Diner
- Kitchen & Pantry
- Driveway Parking
- Substantial Rear Garden
- No Onward Chain Delay



**£150,000**

**BOLTON**  
 11 Institute St, Bolton, BL1 1PZ  
 T: 01204 381 281  
 E: [bolton@cardwells.co.uk](mailto:bolton@cardwells.co.uk)

**BURY**  
 14 Market St, Bury, BL9 0AJ  
 T: 0161 761 1215  
 E: [bury@cardwells.co.uk](mailto:bury@cardwells.co.uk)

**LETTINGS & MANAGEMENT**  
 11 Institute St, Bolton, BL1 1PZ  
 T: 01204 381 281  
 E: [lettings@cardwells.co.uk](mailto:lettings@cardwells.co.uk)

Incorporating: Wright Dickson & Catlow, WDC Estates



Fivegate Ltd. Registered In England No. 1822919. Registered Office: 11 Institute Street, Bolton, BL1 1PZ. Directors: A.R. Cardwell, R.W.L. Cardwell & R.W. Thompson.

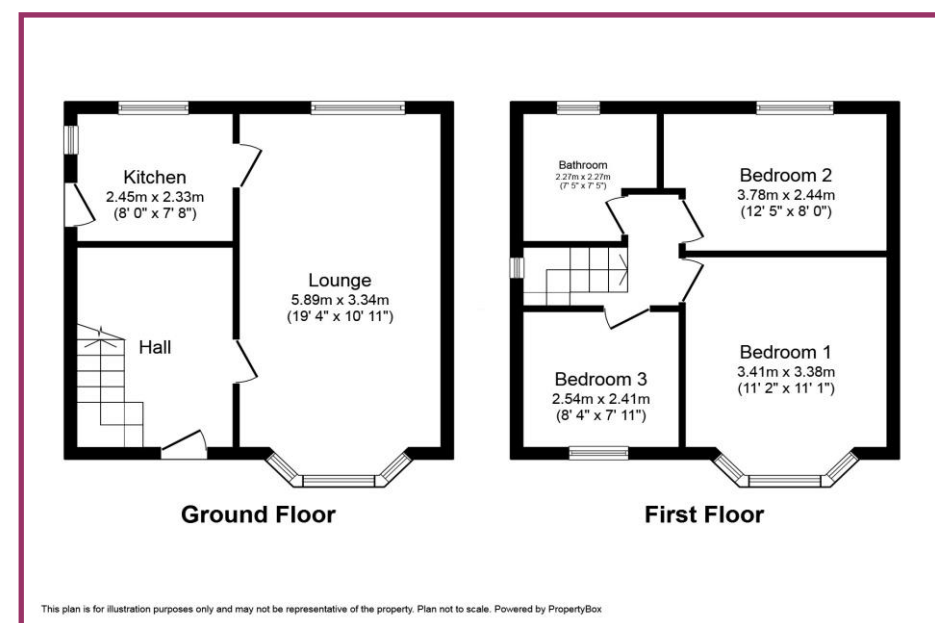



Located in a popular area just off Walmsley Road, this three bedroom semi detached requires some updating and therefore offers the opportunity to personalise and potentially add value. The accommodation briefly comprises entrance hallway, open plan, lounge / dining room, kitchen with pantry offering scope to knock through, three bedrooms and a three-piece shower room. Externally the property enjoys driveway parking to the front with access to the side, leading to a substantial rear garden, which offers much potential, including the possibility of extending the original accommodation, subject to relevant permissions being sought and obtained. Early viewing is strongly advised as properties in this area and offering this potential rarely stay on the market for long. There is a virtual viewing video and physical viewings can be booked. Viewing is highly recommended to appreciate all that is on offer, a personal viewing appointment can be arranged by calling Cardwells Estate Agents Bury on 0161 761 1215, emailing; bury@cardwells.co.uk or visiting: www.Cardwells.co.uk

### **ACCOMMODATION AND APPROXIMATE ROOM SIZES:**

**Hall** Double glazed door to the front elevation leading into the hall double glazed side panels. Stairs lead off to the first floor landing. Radiator.

**Lounge/Diner** 19' 4" x 10' 11" (5.89m x 3.34m) Double glazed bay window to the front elevation with double glazed window to the rear. Two radiators. Wall mounted gas fire. Picture. Door through to kitchen.

**Kitchen** 8' 0" x 7' 8" (2.45m x 2.33m) Double glazed door and window to the side elevation double glazed window to the rear. Range of base units with contrasting work surfaces and matching wall mounted cabinets. Inset sink and drainer. Central heating boiler. Plumbed for washing machine. Four burner gas hole. Door through to pantry.

**Pantry** Double glazed window to the side elevation.

**First Floor Landing** Stairs lead off the hall to the first floor landing. Double glazed window to the side elevation. Loft access.

**Bedroom 1** 11' 2" x 11' 1" (3.41m x 3.38m) Double glazed bay window to the front elevation. Radiator. Fitted wardrobes.

**Bedroom 2** 12' 5" x 8' 0" (3.78m x 2.44m) Double glazed window to the rear elevation. Radiator.

**Bedroom 3** 8' 4" x 7' 11" (2.54m x 2.41m) Double glazed window to the rear elevation. Radiator.

**Shower Room** 7' 5" x 7' 5" (2.27m x 2.27m) Double window to the rear elevation. Three-piece suite comprising walk in shower cubicle, pedestal wash, handbasin and close. Coupled WC. Radiator.

**Externally** The front of the property enjoys block paved driveway parking for up to two vehicles with access around the side, leading to a substantial garden with paved patio area lawn which is both fence and hedge enclosed.

**Price** £150,000

**Tenure** The premarketing research that Cardwells Estate Agents Bury have completed shows that the property is FREEHOLD. We encourage all interested parties to seek clarification of this from their solicitor.

**Council Tax** The property is situated in the Borough of Bury and is therefore liable for Bury Council Tax. The property is C rated which is at an approximate annual cost of £1,842 (at the time of writing).

**Conservation area** Cardwells Estate Agents Bury pre-marketing research indicates that the property is not set within a conservation area.

**Flood Risk** Cardwells Estate Agents Bury pre-marketing research indicates that this family home is in a position which is regarded as having a "very low" risk of flooding.

**Viewing** Viewing is highly recommended to appreciate all that is on offer, a personal viewing appointment can be arranged by calling Cardwells Estate Agents Bury on 0161 761 1215, emailing; bury@cardwells.co.uk or visiting: www.Cardwells.co.uk

**Disclaimer** This brochure and the property details are a representation of the property offered for sale or rent, as a guide only. Content must not be relied upon as fact and does not form any part of a contract. Measurements are approximate. No fixtures or fittings, heating system or appliances have been tested, nor are they warranted by Cardwells Estate Agents Bury, or any staff member in any way as being functional or regulation compliant. Cardwells Estate Agents Bury do not accept any liability for any loss that may be caused directly or indirectly by the information provided, all interested parties must rely on their own, their surveyor's or solicitor's findings. We advise all interested parties to check with the local planning office for details of any application or decisions that may be consequential to your decision to purchase or rent any property. Any floor plans provided should be used for illustrative purposes only. Any leasehold properties both for sale and to let, may be subject to leasehold covenants, if so further details will be available by request. All clients monies held in our Clients Account are overseen and monitored by Chartered Accountants. Cardwells estate Agents Bury are members of the property ombudsman redress scheme. All clients money is protected with Clients Money Protection (CMP). "Cardwells Estate Agents Bolton, Cardwells Estate Agents Bury, Cardwells Lettings Agents Bolton and Cardwells Lettings Agents Bury are trading names of Fivegate Ltd"

